

This document is the property of Amphenol Corporation and is delivered on the express condition that it is not to be disclosed, reproduced or used, in whole or in part, for manufacture or sale by anyone other than Amphenol Corporation without its prior consent, and that no right is granted to disclose or to use any information in this document.

CUSTOMER DRAWING ORIGINAL

REVISIONS				
SYM	ECN No.	DESCRIPTION	DATE	APPROVED
A		RELEASE FOR RoHS	02/17/2006	Armstrong Kao

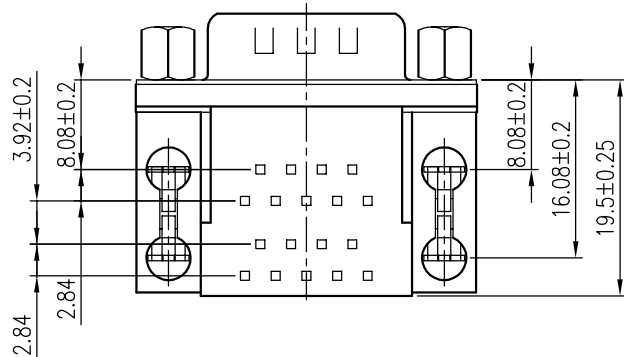
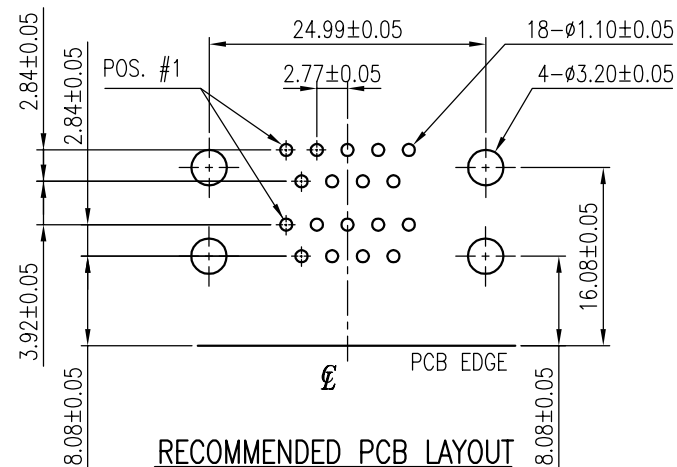
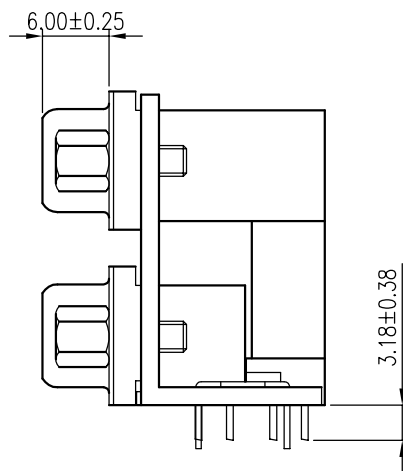
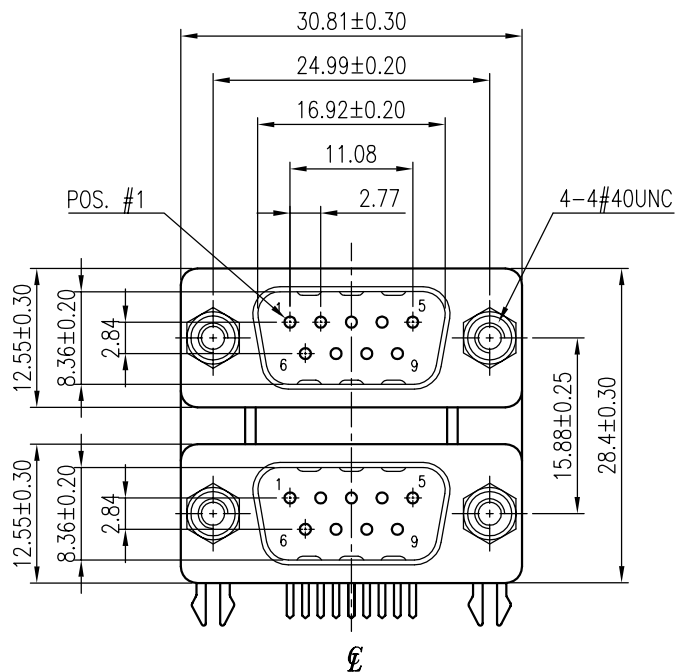

NOTES:

1. FRONT SHELL: COLD ROLLER STEEL, SELECTIVE PLATED
2. CONTACT: BRASS, SELECTIVE GOLD PLATED ON CONTACT AREA
TIN PLATED ON SOLDERING AREA
3. INSULATOR: PBT, UL 94V-0, COLOR- BLACK
4. TOP CONNECTOR: 9-POS. PLUG
BOTTOM CONNECTOR: 9-POS. PLUG
5. THIS PRODUCT DOESN'T CONTAIN ENVIRONMENTAL HAZARDOUS MATERIAL PER DIRECTIVE 2002/95/EC FOR RoHS.
6. THE PRODUCT MUST BE FOR DIP PROCESS ONLY

TOLERANCE m/m	APPROVALS	DATE	TITLE		<h2 style="margin: 0;">Amphenol®</h2> <p style="margin: 0;">Amphenol Corporation Amphenol Taiwan Corporation</p>			
x. ±0.30	DRAWN Sondra Sang	02/17/06	G17H SERIES 8.08 FOOTPRINT R/A PCB MOUNT 15.88 MM C-C, 9P/9P					SCALE
x.x ±0.25	CHECKED <input type="checkbox"/> Jeff Liu	02/17/06			SIZE	PART NO.	DRAWING NO.	REV.
x.xx ±0.15	APPROVED <input type="checkbox"/> Jeff Liu	02/17/06			A4	G17H 111 XX31 EU	DSUB-G17H111XX31EU-25	A
x.xxx ±0.08								
ANGULAR ±2°								
UNLESS OTHERWISE SPECIFIED		UNIT MM						