

This document is the property of Amphenol Corporation and is delivered on the express condition that is not to be disclosed, reproduced or used, in whole or in part, for manufacture or sale by anyone other than Amphenol Corporation without its prior consent, and that no right is granted to disclose or to use any information in this document.

The marking on this product doesn't contain environmental hazardous materials per Material Specification 55-00259 for Sony GP compliant or per directive 2002/95/EC for RoHS compliant.



ORIGINAL



REVISIONS				
SYM	ECN No.	DESCRIPTION	DATE	APPROVED
A		RELEASE TO PRODUCTION	11/13/2008	Hank Hsu

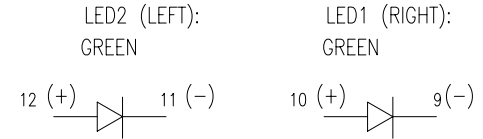
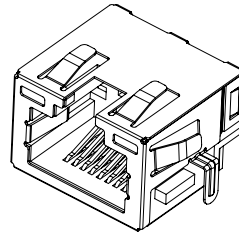
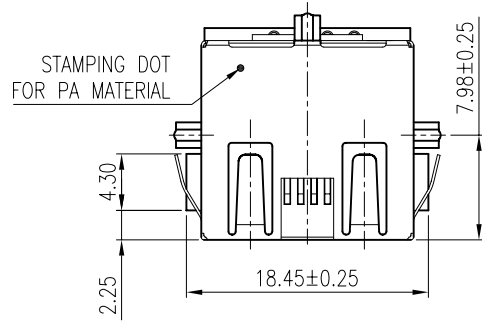

CIRCUIT OF LED

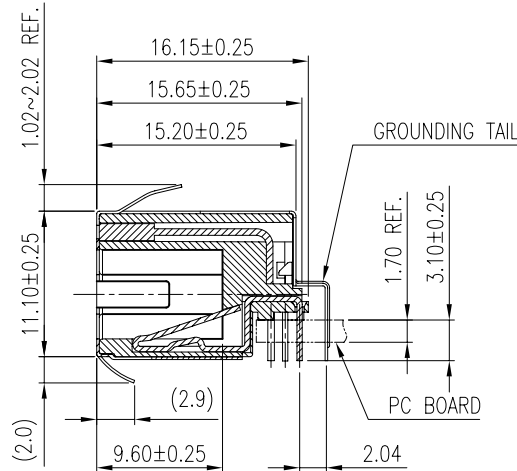
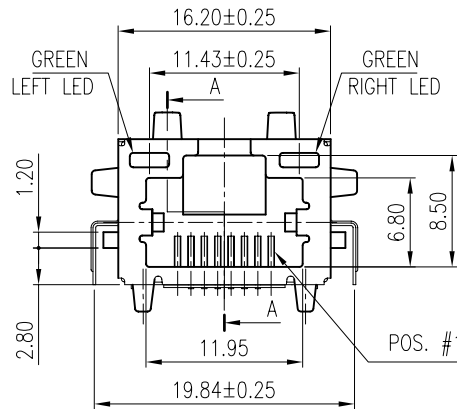

SECTION A-A

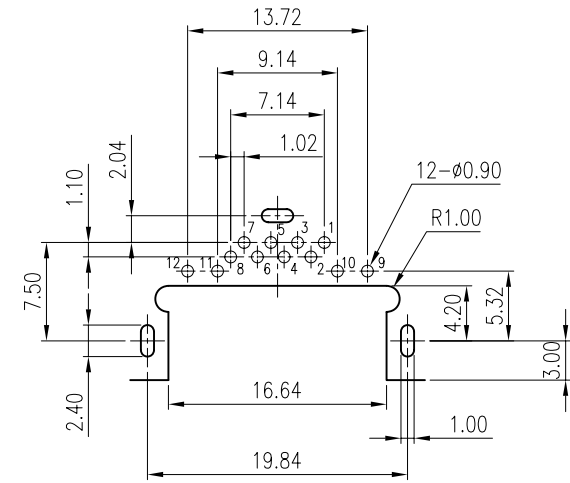

RECOMMENDED PCB LAYOUT (TOP VIEW)

(ALL TOLERANCES ARE ±0.05)

NOTES:

- INSULATOR: LCP, UL 94V-0, COLOR- BLACK
- CONTACT: PHOSPHOR BRONZE C5191 E-H, 0.35 MM THICKNESS, SELECTIVE GOLD PLATED ON CONTACT AREA, 100µ" MIN. MATTE TIN PLATED ON SOLDERING AREA, 50µ" MIN. NICKEL UNDER-PLATING OVERALL
- SHIELDED: PHOSPHOR BRONZE C5191, 0.25 MM THICKNESS, TIN PLATED
- LED MUST BE THE HIGH TEMPERATURE MATERIAL
- THIS PRODUCT DOESN'T CONTAIN ENVIRONMENTAL HAZARDOUS MATERIALS PER DIRECTIVE 2002/95/EC FOR RoHS COMPLIANT.

G71B 0204 4 22 PEU	50µ"
G71B 0204 3 22 PEU	30µ"
G71B 0204 2 22 PEU	15µ"
G71B 0204 1 22 PEU	6µ"
PART NUMBER	FINISH

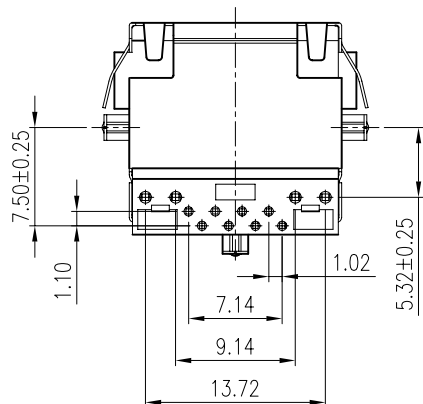

TOLERANCE	APPROVALS	DATE	TITLE	UNIT	SCALE	SIZE	PART No.
X. ±0.30	DRAWN Sondra Sang	11/13/08	MODULAR JACK, 8P8C, DIP TYPE SIDE ENTRY, W/SH & LED SLIM TYPE, TAPE & REEL PACKING	mm	A3	G71B 0204 X22 PEU	
X.X ±0.20	CHECKED Chenny Yeh	11/13/08					
X.XXX ±0.10	APPROVED Hank Hsu	11/13/08		NA	1 OF 2	G71B0204X22PEU	
ANGULAR ±1°	DWG TYPE CUST DWG	PROJECT CODE MJK		SCALE	SHEET		REV. A
UNLESS OTHERWISE SPECIFIED							

Amphenol[®]
Amphenol Corporation
Amphenol Taiwan Corporation

This document is the property of Amphenol Corporation and is delivered on the express condition that it is not to be disclosed, reproduced or used, in whole or in part, for manufacture or sale by anyone other than Amphenol Corporation without its prior consent, and that no right is granted to disclose or to use any information in this document.

The marking on this product doesn't contain environmental hazardous materials per Material Specification 55-00259 for Sony GP compliant or per directive 2002/95/EC for RoHS compliant.



ORIGINAL



REVISIONS				
SYM	ECN No.	DESCRIPTION	DATE	APPROVED
A		RELEASE TO PRODUCTION	11/13/2008	Hank Hsu

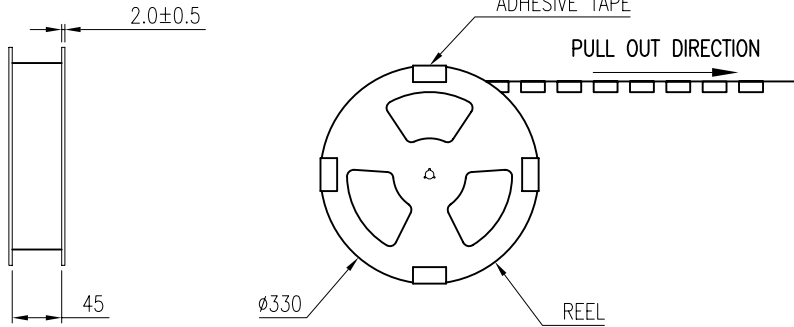
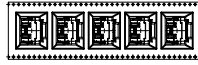

PULL OUT DIRECTION

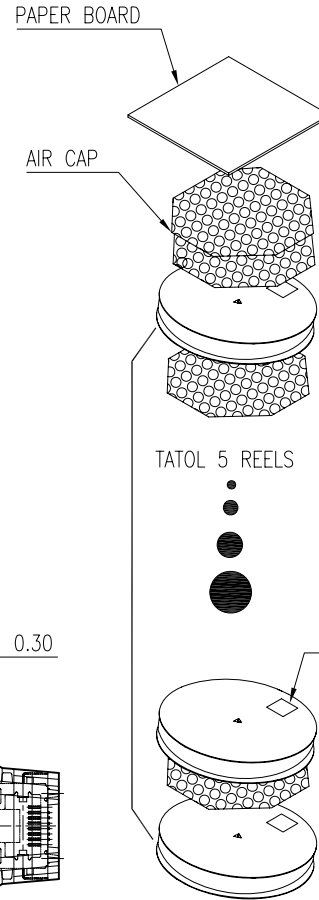

TATOL 5 REELS

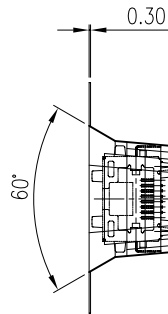
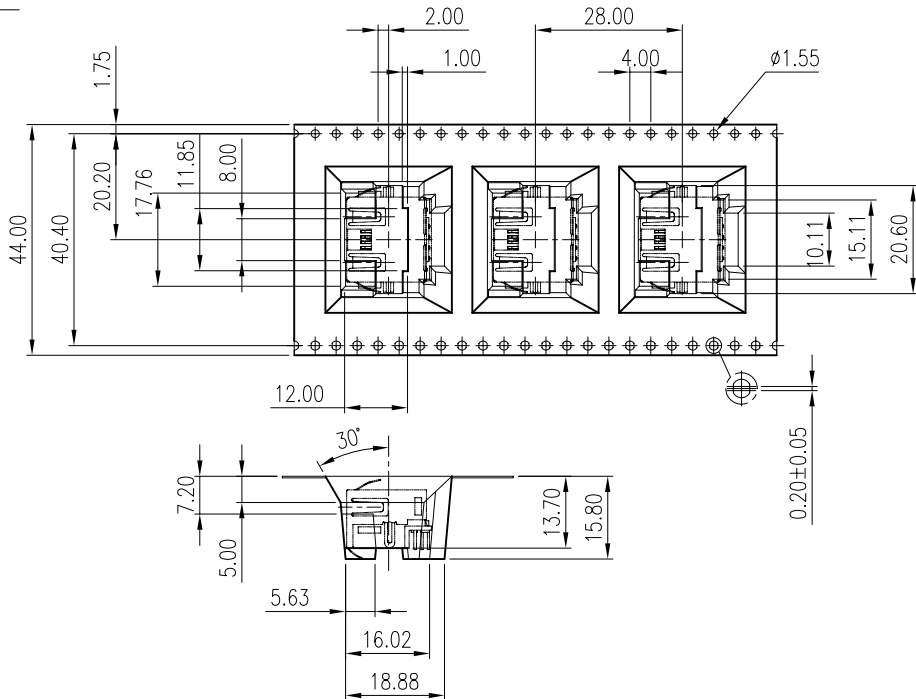
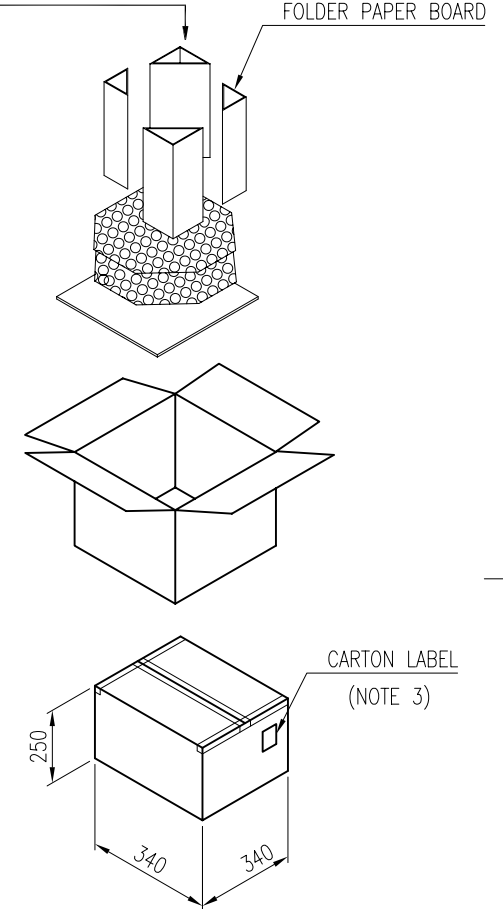

NOTES:

1. PRIMARY PACKING: 120 PCS/ PER REEL
2. SECONDARY PACKING: 5 REELS (600 PCS) / PER CARTON
3. THE LABELS MUST BE SHOWN Amphenol P/N & QUANTITY
4. THIS PRODUCT DOESN'T CONTAIN ENVIRONMENTAL HAZARDOUS MATERIALS PER DIRECTIVE 2002/95/EC FOR RoHS COMPLIANT.

APPROVALS		DATE	MODULAR JACK, 8P8C, DIP TYPE		Amphenol [®] Amphenol Corporation Amphenol Taiwan Corporation		
DRAWN	Sondra Sang	11/13/08	SIDE ENTRY, W/SH & LED				
CHECKED	Chenny Yeh	11/13/08	SLIM TYPE, TAPE & REEL PACKING		PART No.		
APPROVED	Hank Hsu	11/13/08	UNIT	mm	SIZE	A3	G71B 0204 X22 PEU
DWG TYPE	CUST DWG	PROJECT CODE	SCALE	NA	SHEET	2 OF 2	DWG No.
		MJK					G71B0204X22PEU_1
							REV.
							A